



JCT
Analysentechnik

JER & JHD Sampling Pipes & Pre-Filters



Gas Sampling Probes

Heated Sample Lines

Sample Gas Coolers

Condensate Treatment

Accessories

Gas Conditioning Systems

Sample Gas Converters

APPLICATION

- Extractive gas analysis
- Emission and process monitoring
- Gas sampling at corrosive process gases
- Gas sampling at process temperatures up to 1800 °C
- Gas sampling at high dust concentrations > 2 g/m³
- For adaption to all stationary **JCT** gas sampling probes

BENEFITS

- Easy mounting
- Optimal adaption of **JCT** gas sampling probes to the widest range of sampling conditions due to a huge variety of products
- Precisely definable gas sampling point due to huge variety of sampling and extension pipes
- Pre-filter with v-deflector applicable also at high flow velocities in the process without damage
- Simple exchange

FEATURES

- Wide range of different sampling pipe and pre-filter materials
- Wide range of different sampling pipe and pre-filter lengths
- All sampling pipes and pre-filters with G 3/4" male connection thread
- Wide range of different extension tubes for pre-filter placement in the process
- Pre-filter also with v-deflector for protection against abrasion
- All sampling pipes and pre-filters with mounting hexagon

TECHNICAL DATA

Model	JER-T	JER-H	JER-IN825	JER-S	JER-R	JER-K	JER-C (X)
Description	sampling pipes for gas sampling in the process						
Material	Teflon® (PTFE)	Hastelloy®C22	Inconel®825	SS316	SS314	Kanthal®	Ceramic (Al ₂ O ₃)
Operation							
Max. sample gas temperature	140 °C	425 °C	550 °C	600 °C	1120 °C	1250 °C	1800 °C
Dust concentration	max. 2g/m ³						
Operating pressure	max. 7 bara						
Mounting angle	5° to 15° incline (recommended)						
Construction							
Outer diameter	approx. 27 mm						approx. 24 (33) mm
Lengths „L“ [mm]	500 / 1000 / 1500	1000 / 1500 / 2000	1000 / 1500 / 2000	300 / 500 / 1000 / 1500 / 2000 / 2500 / 3000	1000 / 1500 / 2000	1000 / 1500 / 2000	1000 / 1500
Connection thread	G 3/4" male						

Sampling pipes JER-T/S/H/K (PTFE/SS316/SS314/Hastelloy®/Kanthal®/Inconel®)

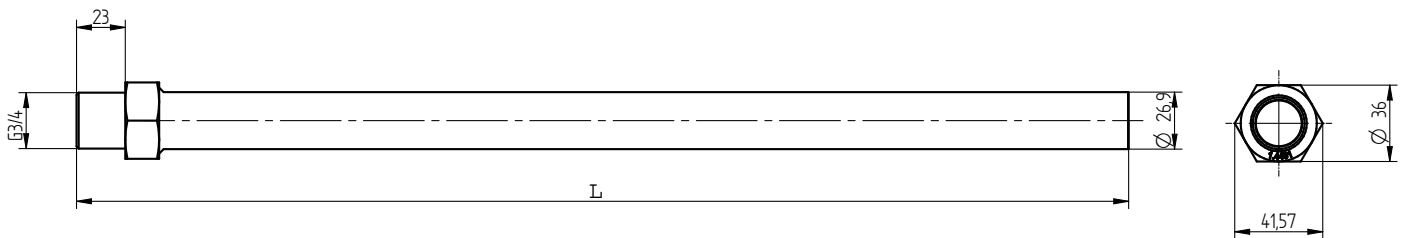

Sampling pipes JER-C (Ceramic)

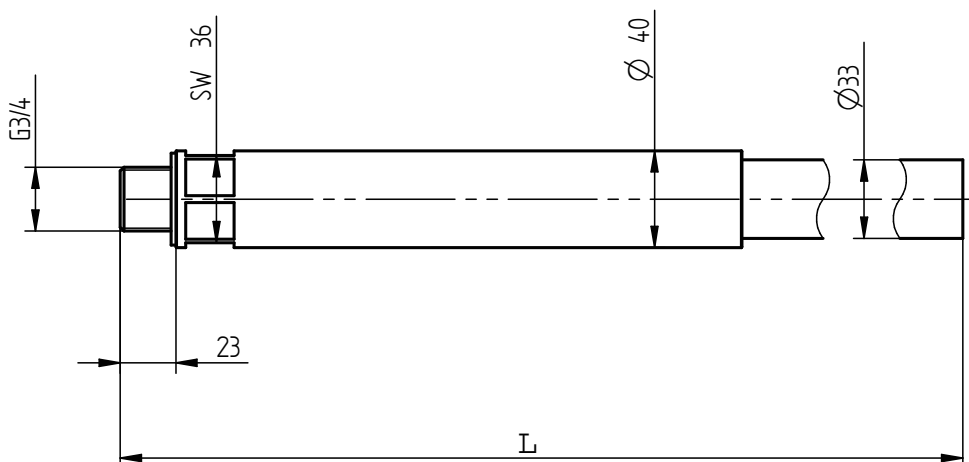

Dimensions in mm

TECHNICAL DATA

Model	JHD-S	JHD-H	JHD-HC	JHD-I600	JHD-HX	JHD-S...V
Description	In-situ pre-filters for gas sampling in the process					
Material	SS316L	Hastelloy®C22	Hastelloy®C276	Inconel®600	Hastelloy®X	SS316L
Deflector	no	no	no	no	no	yes

Operation

Max. temperature	540 °C	650 °C	650 °C	700 °C	930 °C	540 °C
Dust concentration	< 10 g/m ³ (330 mm length) / < 30 g/m ³ (500 mm length) / ≥ 30 g/m ³ (1000 mm length)					
Operating pressure	max. 7 bara					
Mounting angle	5° to 15° incline (recommended)					

Construction

Outer diameter	approx. 50 mm					
Lengths „L“	330 / 500 / 1000 mm					
Porosity	3 µm (JHD-S05 and JHD-S05V also 10µm)					
Connection	G 3/4" male					

In-situ pre-filter JHD-S / JHD-H

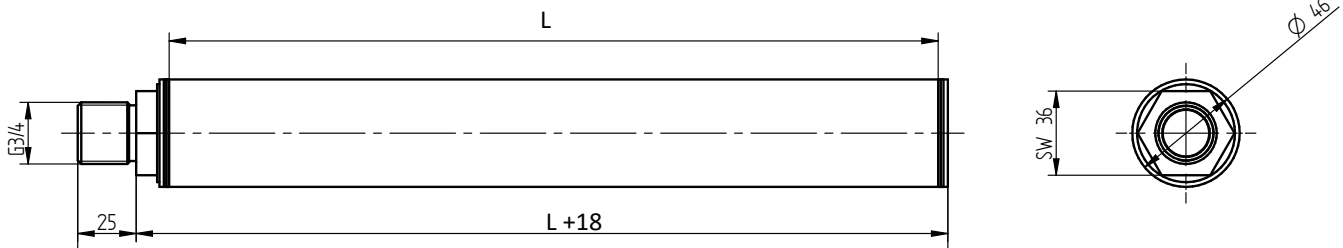

In-situ pre-filter with V-deflector JHD-S...V

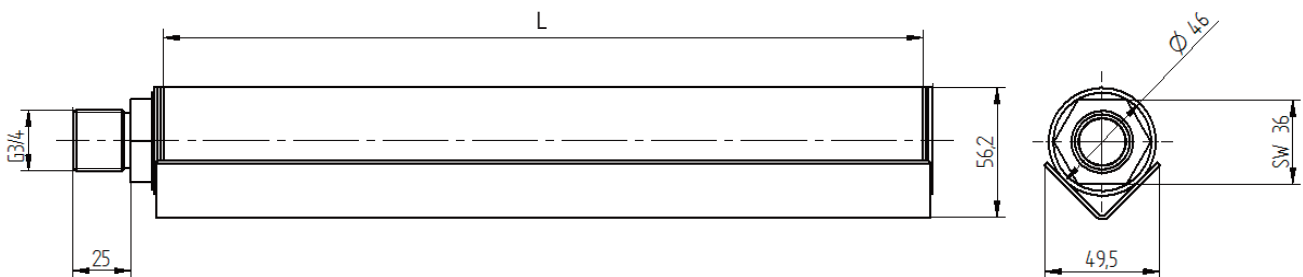

Extension tubes JHD-ET and JHD-ETK for pre-filters

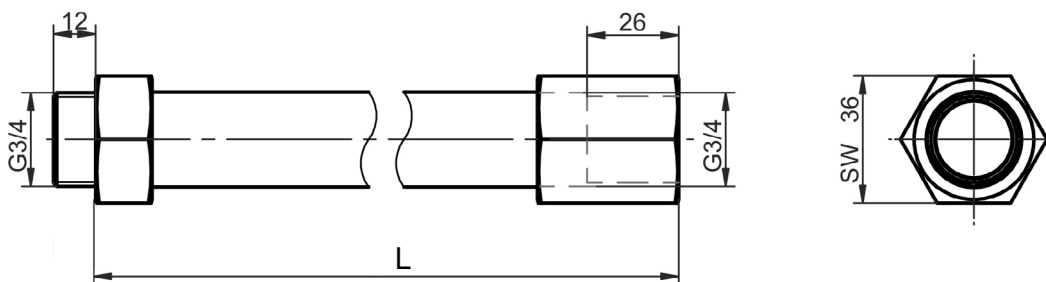

Dimensions in mm

ORDER CODES

Sampling Pipes JER with G 3/4" male thread

Order Code Description

35.00066	JER-S03, SS316, length 300 mm
35.00067	JER-S05, SS316, length 500 mm
35.00060	JER-S10, SS316, length 1000 mm
35.00061	JER-S15, SS316, length 1500 mm
35.00062	JER-S20, SS316, length 2000 mm
35.00063	JER-S25, SS316, length 2500 mm
35.00065	JER-S30, SS316, length 3000 mm
35.00050	JER-K10, Kanthal®, length 1000 mm
35.00051	JER-K15, Kanthal®, length 1500 mm
35.00052	JER-K20, Kanthal®, length 2000 mm
35.00082	JER-T05, Teflon® (PTFE), length 500 mm
35.00080	JER-T10, Teflon® (PTFE), length 1000 mm
35.00081	JER-T15, Teflon® (PTFE), length 1500 mm
35.00070	JER-R10, SS314, length 1000 mm
35.00071	JER-R15, SS314, length 1500 mm
35.00072	JER-R20, SS314, length 2000 mm
35.00055	JER-H10, Hastelloy®C22, length 1000 mm
35.00056	JER-H15, Hastelloy®C22, length 1500 mm
35.00057	JER-H20, Hastelloy®C22, length 2000 mm
35.00085	JER-H10, Hastelloy®C276, length 1000 mm
35.00086	JER-H15, Hastelloy®C276, length 1500 mm
35.00087	JER-H20, Hastelloy®C276, length 2000 mm
35.00040	JER-C10, Ceramic (Al ₂ O ₃), length 1000 mm, Ø a 24 mm
35.00041	JER-C15, Ceramic (Al ₂ O ₃), length 1500 mm, Ø a 24 mm
35.00042	JER-C10X, Ceramic (Al ₂ O ₃), length 1000 mm, Ø a 33 mm
35.00043	JER-C15X, Ceramic (Al ₂ O ₃), length 1500 mm, Ø a 33 mm
35.00045	JER-IN825-10, Inconel®825, length 1000 mm
35.00046	JER-IN825-15, Inconel®825, length 1500 mm
35.00047	JER-IN825-20, Inconel®825, length 2000 mm

K3560587 Customisation of sampling pipe length

Extension Tubes JHD-ET for pre-filters JHD

with G 3/4" male thread

Order code description

35.00929	JHD-ETK10, Kanthal®, length 1000 mm
35.00928	JHD-ETK15, Kanthal®, length 1500 mm
35.00927	JHD-ETK20, Kanthal®, length 2000 mm
35.00926	JHD-ETK25, Kanthal®, length 2500 mm
35.00935	JHD-ETH07, Hastelloy®C22, length 700 mm
35.00936	JHD-ETH10, Hastelloy®C22, length 1000 mm
35.00937	JHD-ETH15, Hastelloy®C22, length 1500 mm
35.00938	JHD-ETH20, Hastelloy®C22 length 2000 mm
35.00900	JHD-ETHX07, Hastelloy®X, length 700 mm
35.00931	JHD-ETHX10, Hastelloy®X, length 1000 mm
35.00932	JHD-ETHX15, Hastelloy®X, length 1500 mm
35.00933	JHD-ETHX20, Hastelloy®X, length 2000 mm

Pre-Filters JHD with G 3/4" male thread

Order Code Description

35.00703	JHD-S03, SS316L, length 330 mm, 3 µm
35.00705	JHD-S05, SS316L, length 500 mm, 3 µm
35.00788	JHD-S03, SS316L, length 330 mm, 10 µm
35.00710	JHD-S10, SS316L, length 1000 mm, 3 µm
35.00790	JHD-S05, SS316L, length 500 mm, 10 µm
35.00789	JHD-S10, SS316L, length 1000 mm, 10 µm
35.00793	JHD-H03, Hastelloy®, length 330 mm, 3 µm
35.00792	JHD-H05, Hastelloy®, length 500 mm, 3 µm
35.00791	JHD-H10, Hastelloy®, length 1000 mm, 3 µm
35.00794	JHD-HX03, Hastelloy®X, length 330 mm, 3 µm
35.00795	JHD-HX05, Hastelloy®X, length 500 mm, 3 µm
35.00796	JHD-HX10, Hastelloy®X, length 1000 mm, 3 µm
35.00803	JHD-S03V, SS316L with V-deflector, length 330 mm, 3 µm
35.00805	JHD-S05V, SS316L with V-deflector, length 500 mm, 3 µm
35.00810	JHD-S10V, SS316L with V-deflector, length 1000 mm, 3 µm
35.00888	JHD-S03V, SS316L with V-deflector, length 330 mm, 10 µm
35.00890	JHD-S05V, SS316L with V-deflector, length 500 mm, 10 µm
35.00889	JHD-S10V, SS316L with V-deflector, length 1000 mm, 10 µm
35.00891	JHD-H03V, Hastelloy® with V-deflector, length 330 mm, 3 µm
35.00892	JHD-H05V, Hastelloy® with V-deflector, length 500 mm, 3 µm
35.00893	JHD-H10V, Hastelloy® with V-deflector, length 1000 mm, 3 µm
35.00894	JHD-HX03V, Hastelloy®X with V-deflector, length 330 mm, 3 µm
35.00895	JHD-HX05V, Hastelloy®X with V-deflector, length 500 mm, 3 µm
35.00896	JHD-HX10V, Hastelloy®X with V-deflector, length 1000 mm, 3 µm

Gas Sampling Probes

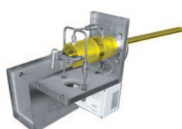

Heated Sample Lines



Sample Gas Coolers



Gas Conditioning Systems



NOx Converter

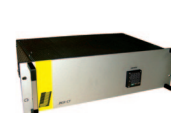

and solutions for

