

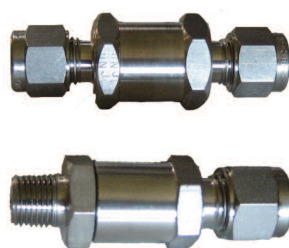

Accessories for JES-301

JCT
Analysentechnik

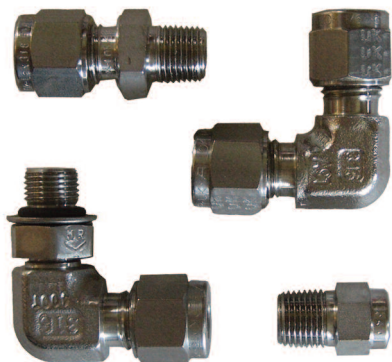
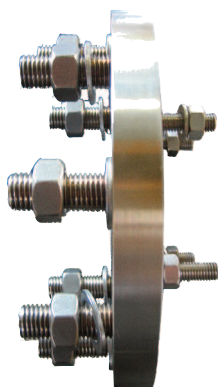

Gas Sampling Probes

Heated Sample Lines

Sample Gas Coolers

Condensate Treatment

Accessories

Gas Conditioning Systems

Sample Gas Converters

FLANGE ADAPTER

Part.No.	Flange adapter	Material	
35.08110	DN65/PN6 to 1" ANSI 150 lbs	SS316	Threaded bolts 4xM12 and 4xM16
35.08070	DN65/PN6 to 2" ANSI 150 lbs	SS316	Threaded bolts 4xM12 and 4xM16
35.08015	DN65/PN6 to 2 1/2" 150 lbs	SS316	Threaded bolts 4xM12 and 4xM16
35.08025	DN65/PN6 to 3" ANSI 150 lbs	SS316	Threaded bolts 4xM12 and 4xM16
35.08100	DN65/PN6 to 4" ANSI 150 lbs	SS316	Threaded bolts 4xM12 and 4xM20
35.08080	DN65/PN6 to 4" ANSI 300 lbs	SS316	Threaded bolts 4xM12 and 8xM20
35.08090	DN65/PN6 to 6" ANSI 150 lbs	SS316	Threaded bolts 4xM12 and 8xM20
35.08035	DN65/PN6 to DN80/PN6	SS316	Threaded bolts 4xM12 and 4xM16
35.08040	DN65/PN6 to DN100/PN25	SS316	Threaded bolts 4xM12 and 8xM20
35.01401	Thermal spacer DN65/PN6 320 mm	SS316	4 holes for M12

Dimensions according to EN 1092-1 and ASME B16.5. Scope of delivery: flange, nuts and washers

ACCESSORIES FOR GAS CONNECTIONS

Part.No.	Accessories for gas connections (SS316)	Part.No.	Accessories for gas connections (SS316)
35.90080	Male connector for 6 mm tube / 1/8" NPT	35.90120	Union 6 mm to 6 mm tube
35.90081	Male connector for 8 mm tube/ 1/8" NPT	35.90121	Reduction union 6 mm to 8 mm tube
35.90086	Male connector for 10 mm tube, 1/8" NPT	35.90122	Reduction union 6 mm to 10 mm tube
35.90130	Male connector for 12 mm tube, 1/8" NPT	35.90123	Reduction union 6 mm to 12 mm tube
35.90082	Blind plug 1/8" NPT male thread	35.90124	Reduction union 6 mm to 1/4" mm tube
35.90083	Male connector for 1/4" tube, 1/8" NPT	35.90125	Reduction union 6 mm to 5/6" mm tube
35.90131	Male connector for 5/6" tube, 1/8" NPT	35.90126	Reduction union 6 mm to 3/8" mm tube
35.90084	Male connector for 3/8" tube, 1/8" NPT	35.90127	Reduction union 6 mm to 1/2" mm tube
35.90132	Male connector for 1/2" tube, 1/8" NPT	35.90097	Non return valve 3/8" (200°C), Viton®
35.90085	Elbow connector for 6 mm tube, 1/8" NPT	35.90096	Non return valve 3/8" (320°C), Kalrez®
35.90098	Y-connector for 2x 6 mm pipe, 1/8" NPT	35.90094	Non return valve 1/8" (200°C), Viton®
35.90008	O-ring removal tool	35.90068	Non return valve 1/8" (320°C), Kalrez®
Accessories for heated sample lines			
		35.00970	PG 42 fitting complete
		35.00980	Mounting clamp (35 bis 50 mm)

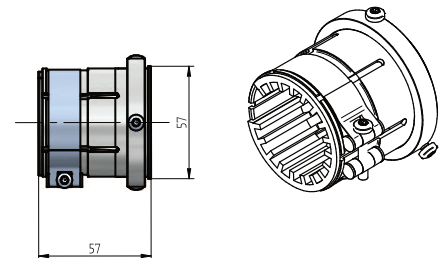
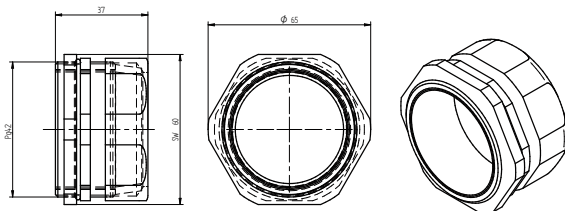

Dimensions in mm

Gas Sampling Probes

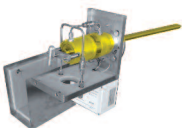

Heated Sample Lines



Sample Gas Coolers



Gas Conditioning Systems



NOx Converter



and solutions for

